

The WINDPLAY Building

El Dorado Hills



Office Space For Lease FASTEST INTERNET IN EDH!

The distinctive **WINDPLAY** Building (formerly the *Tomken Building*) has undergone extensive interior and exterior renovation and is now the most stunning professional building in El Dorado Hills, offering considerable amenities such as:

- | | |
|--|----------------------------|
| Conference Room | Convenient Parking |
| Kitchens on 2 nd and 3 rd Floors | Carports with Solar |
| Suites with Balconies & Views | Elevator |
| 3 rd Floor Glassed-in Patio | Charging Station for Autos |

Current availability:

- Suite 117 846 rsf \$1.65 psf
 - *Suite 360 810 rsf \$1.95 psf
 - *Suite 370 810 rsf \$1.95 psf
- } Can be combined

*Includes private balconies

LEASE RATES INCLUDE ALL UTILITIES
(Tenant provides own janitorial)

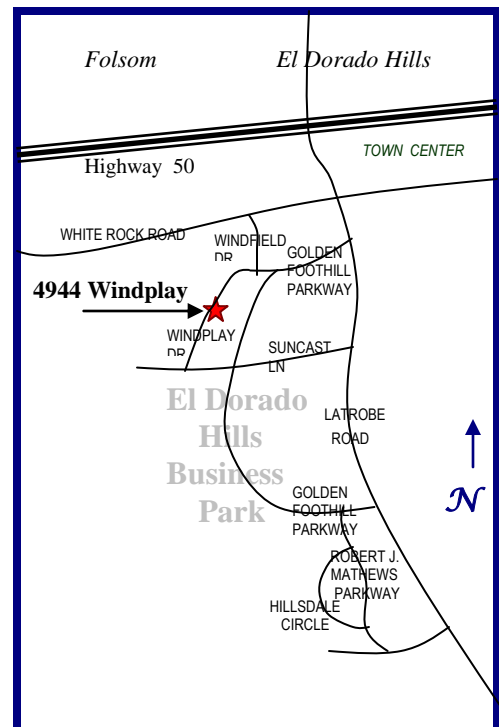

Marilyn Gautschi, Broker (916) 934-6446

AMERICAN COMMERCIAL REAL ESTATE

4944 Windplay Dr., Ste. 380, El Dorado Hills, CA 95762 (916) 934-6446 BRE 00702641 www.americomre.com

The information contained herein has been obtained from the Owner or other reliable sources, however, American Commercial Real Estate does not guarantee the accuracy of the information and Buyers should carefully and independently investigate the

Floorplans

4944 Windplay Dr., El Dorado Hills, CA

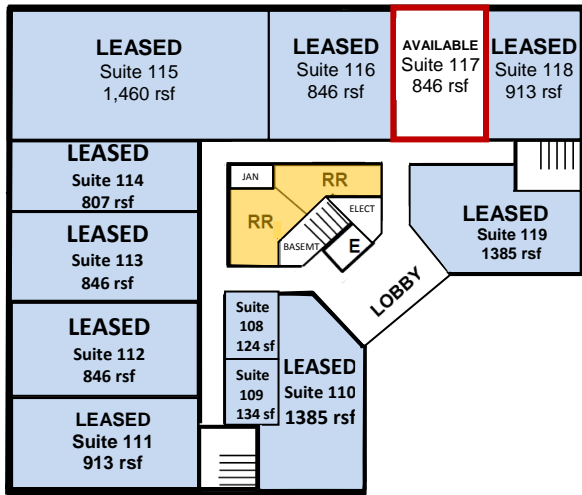

First Floor

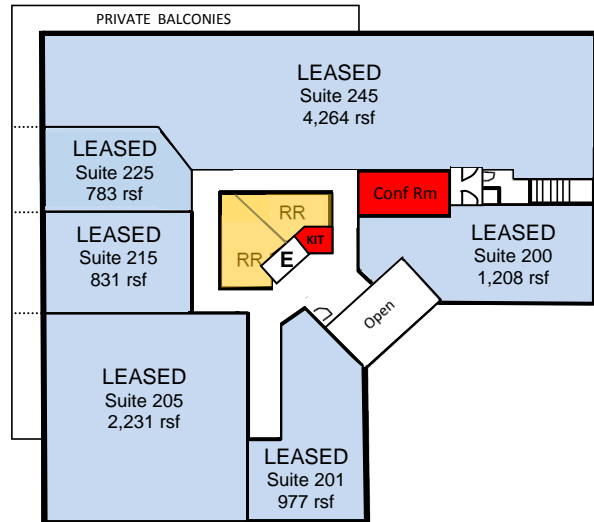

Second Floor

Great views and balconies

INTERNET AVAILABILITY

Comcast Business / Fiber Optic
Metro-Ethernet

AT&T U-verse / Fiber Optic

Fortis Telecom / wireless

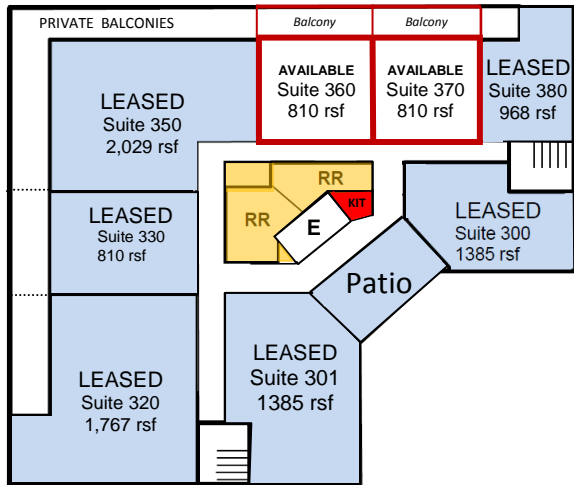

Third Floor

Outstanding Views!

Floorplans are not to scale

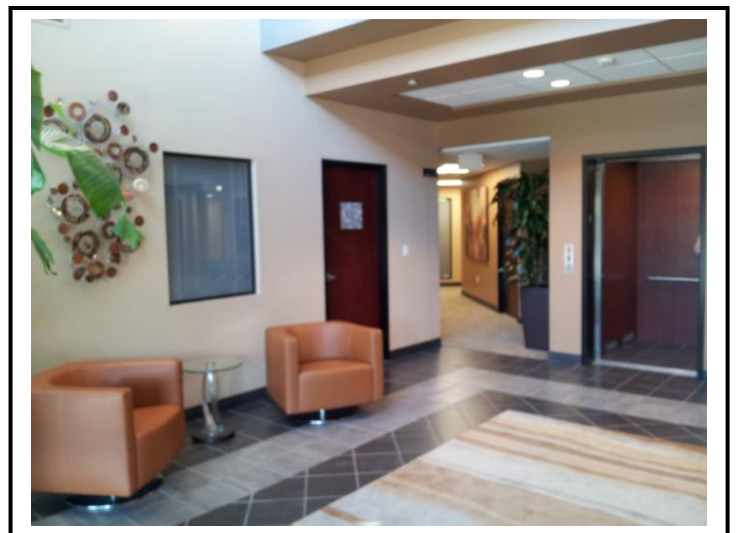

Lobby

Marilyn Gautschi (916) 934-6446

AMERICAN COMMERCIAL REAL ESTATE

4944 Windplay Dr., Ste. 380, El Dorado Hills, CA BRE 00702641